



## Operation Manual – Version 8.

**Please make sure BEFORE you use your trailer you have read this entire booklet and have conducted the pre delivery check list found in the plastic pocket with this Operation Manual.**

**The Pre delivery checklist ensures the trailer is ready to be used.**

Stand the FBT upright wheels on your side.



1. Push wheels apart with knees.



2. Grab the drawbar and walk backwards lowering the trailer onto the ground.



3. Install the removable cross bar and connect with bolts.

The removable cross bar needs to be inserted on its side with the number plate bracket facing upwards. Push to half way on a 45 degree angle then twist 90 degrees.



Removable crossbar.

4. Connect vertical struts to removable crossbar.



5. Place pin in to lock drawbar if required. A boat can be loaded using the brake back feature of the trailer. Once the boat is on the trailer it must be secured tightly at the bow which will lock the position of the drawbar, therefore the locking pin is not required.



6. Place the inner sleeve in the end of the drawbar and fasten with pins and R clips





7. Connect the other end of the drawbar and fasten with pins and R clips.

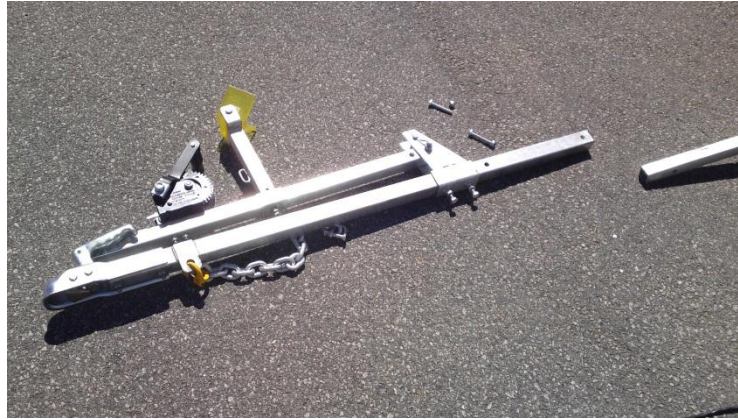

As seen below:



8. Attach to tow bar of car, attach safety chain and attach light socket to car. **The lights** on the trailer already include the number plate light. It can be seen on the left hand side light on its right hand side as seen below.



## Caravan Bracket / carrier – How to attach to the caravan.



1. Bolt bracket to rear bar of caravan. (Bolts are not included with the bracket)
2. Remove the second roller from the back of the trailer.



3. Place the base of the trailer on the base plate of the carrier. Lift the trailer up until the holes in the roller bracket are aligned. Then screw bolts into the hole to secure trailer.







## Kayak / Canoe accessory rail and bracket:

In order to set up the trailer to carry kayak's and or canoes, you will need the kayak / Canoe Accessory rail and bracket with the nuts and bolts. (See to the left)

1 x rail, 1 x Bracket 1 x packet of nuts and bolts to attach the bracket.

1) Attach the bracket to the front drawbar of the trailer as seen here:



2) Slide the rail through the bracket and secure with bolts.



3) Once secure, you can place the carry cradles onto the rails front and back of the trailer or place the kayak's and canoes directly onto the two rails. The **carry cradles** seen below right **ARE NOT INCLUDED** and are sold SEPERATELY.



There are many different styles of kayak carry accessories. (Not purchased from Bulldog)





## **Inflatable Boat Accessory kit - Installation:**

In order to carry your inflatable boat on the Bulldog, you will need to purchase the Inflatable Boat Accessory kit as shown here: (This accessory can be purchased from Bulldog Folding Trailers)



Replace the side skid hull supports with the inflatable boat pontoon roller supports as shown above. Once secure, you can winch the inflatable up onto the trailer.





## Bulldog FBT – Maintenance and Commissioning

It is imperative that the FBT is looked after and maintained to ensure longevity and safe workings of your trailer. This will always ensure hassle free use of your trailer and continuation of the warranty to its full extent.

1. Always check the nuts and bolts of the trailer before use to ensure they are all tightened correctly. This is especially important for the 2 bolts that connect the removable cross member and wheel guards.

**WHEEL and Draw Bar alignment:** - <http://bulldogfoldingtrailers.com.au/photo-video-gallery/>

2. Using a tape measure check that the wheels are square with the trailer. This can also be seen when the trailer is folded as the wheels move in alignment with the trailer at all times. Check left and right alignments.
3. If there is some misalignment then loosen the bolt at the rear of wheel assembly at the outside end of the rear swing arm (As illustrated below). This will allow for the wheels to be towed in or out. **It is very important that the wheels are within 1-2mm** from the measurement of the **front** of the tyre to the main frame and the **back** of the tyre to the main frame. The closer the alignment the less wear you will get on your tyres. It is better to have the wheels slightly towed in at the front than out at the back. Once inline retighten the bolt firmly.

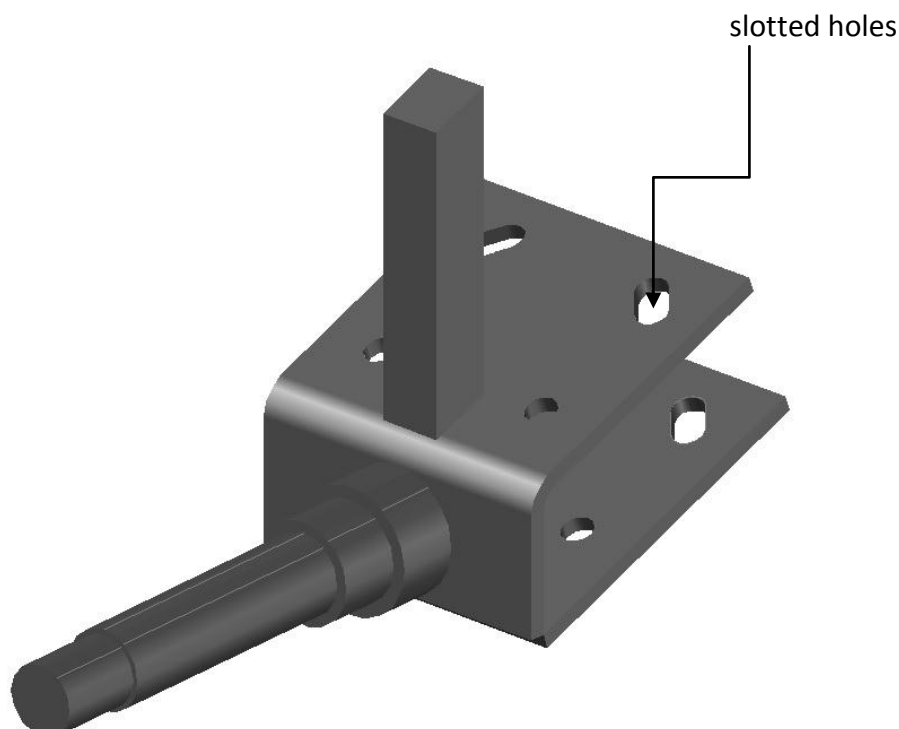



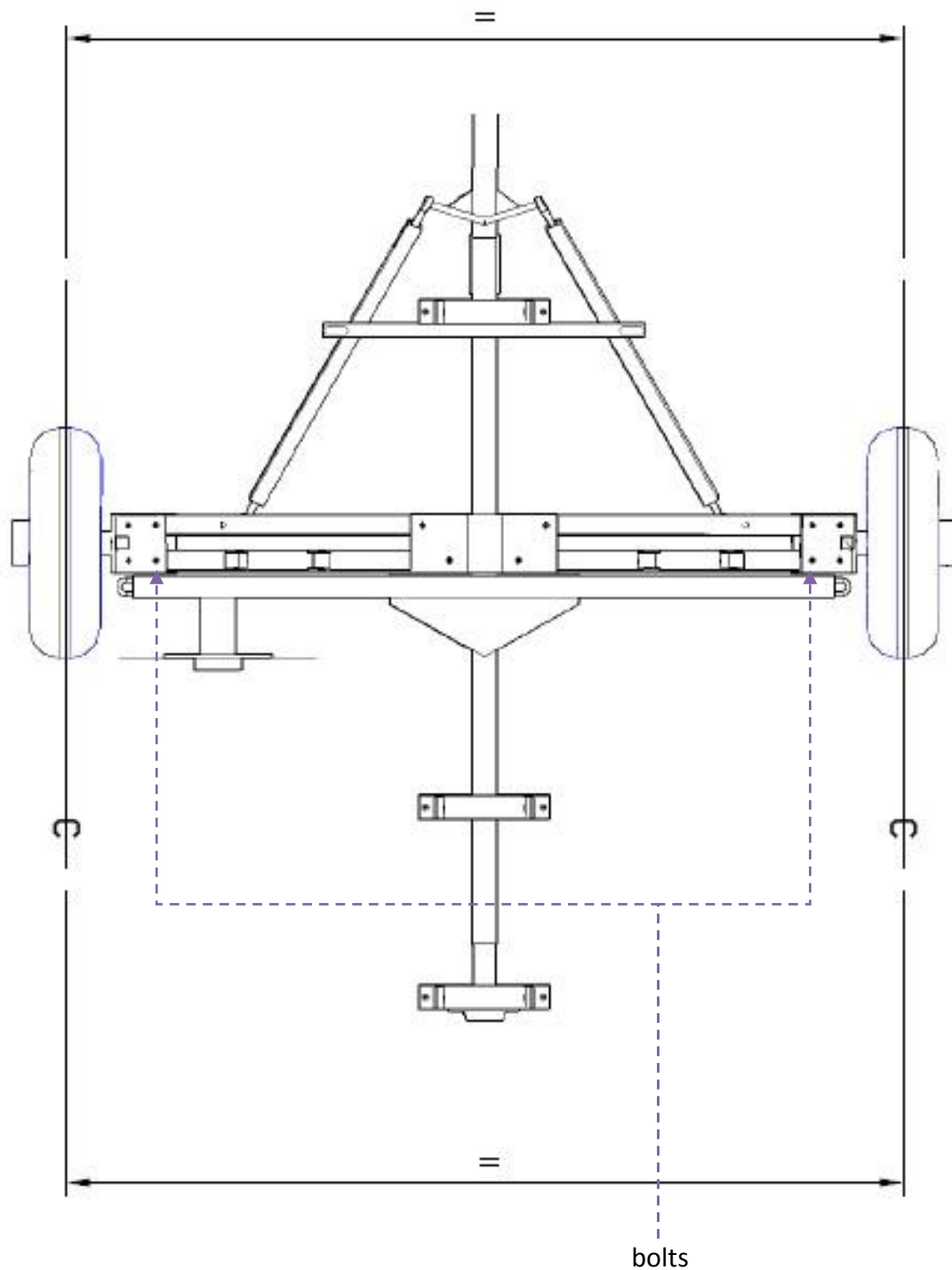

**IMPORTANT:** - If the alignment is not “true” or EXACT you will have excessive wear of the tyres

3. Then fold the trailer up, stand and push the wheels in hard against the trailer frame. Then twist the tie rods simultaneously in the direction that pulls the drawbar into the trailer until the drawbar has a tight spring feeling. Not too tight just enough so that when you move the trailer the hitch does not drag on the ground. Then lock off tie rod lock nuts. Note the drawbar should be roughly in line with the rear frame.

Please see photos over the page.



Wheels pushed hard in



Tyre rod

Lock nut



Twist tyre rod



Firm drawbar



Lock nut

4. Always check the bearings before embarking on long trips. The bearings are **set 14 bearings** and can be purchased from any trailer retailer.

**Ensure that the wheel bearings (set 14) are sufficiently greased at all times.**

5. Tyres should be inflated to the recommended inflation pressure to avoid excessive wear. Recommended pressure with average load 40PSI. If using trailer to maximum capacity inflate to 50PSI.
6. Make sure your trailer is weighted correctly with approximately 20kg of weight on your tow ball. If you have negative weight on your tow ball you will have severe sway in the trailer.

**PARTS for the Bulldog Trailer:**

Parts, such as nuts and bolts and pins etc for the Bulldog Trailers can be generally purchased from any trailer retailer including Bunnings.

The bearings are set 14 and can also be purchased from trailer retailers across Australia.

Bulldog Trailers can also sell these to you direct.

**If you require further information please contact your retailer or go to the Bulldog Folding Trailers website.**

[www.bulldogfoldingtrailers.com.au](http://www.bulldogfoldingtrailers.com.au)